

# DAYLUX Lighting Software



## Key Features

- » Windows based Commissioning Software.
- » Includes USB interface for connection of PC to the Daylux system.
- » Device configuration and programming.
- » Time clock scheduling.
- » System monitoring, reporting and activity history.
- » System back up and restore.
- » Mode Lighting products are guaranteed for two years.

The SET-DPCS (Daylux PC Software) is used to commission the Daylux Lighting Control system. A simple to use windows based software application, designed to be used by commissioning engineers and end users alike. With its Windows Explorer style viewing panes the SET-DPCS software has been developed with a familiar feel and look which PC users will be accustomed to. As the Daylux system is self reliant with distributed intelligence throughout the system, once programmed the SET\_DPCS software is not required to run in the background. The software comes complete with a PC interface that plugs into the PC's USB port providing a two wire connection directly to the Daylux system.



## System Architecture

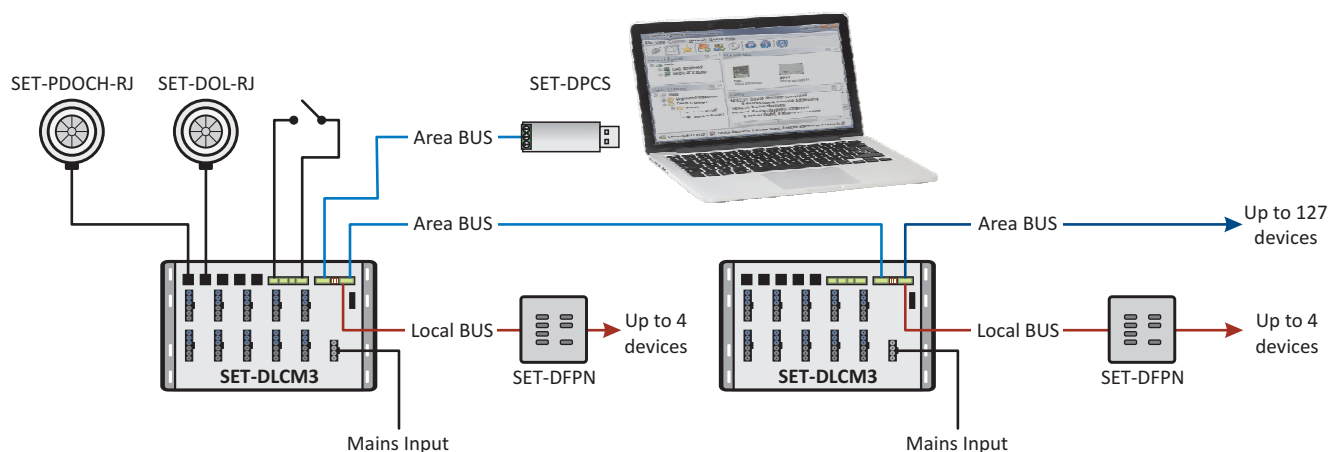

## Installation Diagrams

Figure 1. Wiring.

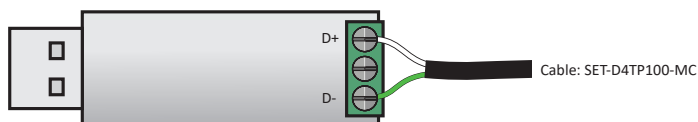

## Technical Data

PC Interface	
Computer Connection	» Plug in USB Dongle
Daylux connection	» Terminals for two wire connection to Daylux system
USB Dongle Driver	» Available from <a href="http://www.modelighting.com/setquare">www.modelighting.com/setquare</a> download
Software	
Software	» Daylux software available from <a href="http://www.modelighting.com/setquare">www.modelighting.com/setquare</a> download
Mechanical	
Dimensions	» L=50mm x W=20mm x D=10mm
Material	» Black Polycarbonate
Weight	» 10g
Operating Temperature	» 0-40°C
IP rating	» Non
Product Codes	
SET-DPCS	» Software and PC interface

## Works With

Product Codes	Description
SET-DAC	» Area Controller
SET-DLCM3	» Pluggable Lighting Control Module
SET-DLCM5	» Pluggable Lighting Control Module
SET-DDC1	» Hard Wired Lighting Control Module
SET-DDC2	» Hard Wired Lighting Control Module
SET-DDC4	» Hard Wired Lighting Control Module

