

# Application

## Commercial



### Western Transit Shed - Kings Cross / London



## Specification

When Hoare Lea one of the UK's largest M & E consultancy practices made the decision to move their London head office to a new prestigious location in the Western Transit Shed complex behind Kings Cross Station, it was important that the design and operation of this office reflected their expertise in the M & E world.

Whilst the lighting had to be controlled with energy efficiency very much in mind, it was also paramount that this open plan space had the right look and feel to act as a showcase for the skill and flair of their very own in-house lighting design team. The convention for a network of zoned presence detectors leading to a 'patchy' look was not going to be acceptable. Mode Lighting and its EcoControl system was chosen by the Hoare Lea lighting design team as it offered a solution that was going to meet their exacting needs. Lighting therefore stays on during core hours but starts to fade off at the end of the working day. Staff working late can re-instate the lighting in their zone by way of a PC supported floor plan, the lighting remaining active until the next timed fade-to-off signal.

The DALI protocol is generally employed for the control of the lighting, with track mounted fluorescent luminaires being daylight linked to provide a maintained illuminance level. RGB backlit acoustic panels to the first floor assist in creating a sunset and sunrise hue effect.

Meeting Rooms and Partner offices have white light for general illumination with a RGB backlit stretch fabric ceiling feature. The RGB luminaires are DMX controlled, generally using just 3 DMX channels, but in order to demonstrate the full control possibilities offered by DMX, some rooms are using 48 or indeed 78 DMX channels. Local plates allow the room users to select the preset levels and colour effects.

## Key Features

- » Maintained illuminance throughout the office.
- » Daylight linked areas that have exposure to natural light.
- » End-of-day timed sweep off and zoned re-instatement of lighting via PC graphic.
- » BMS interface with Fresh Air Terminals (FAT) in the meeting rooms.
- » Intruder Security System interface to switch all lighting off when security system 'armed'.
- » Fire Alarm interface to bring all lighting to 100% to aid evacuation.
- » Interface with iCensia/Savant iPad end-user visualisation and control software.
- » DALI lamp and control gear fault reporting to the EcoControls web browser.
- » Presence detection in meeting rooms.

## A Selection Of Products Used



### Eco Controls Control Plate ECO-MCP-55-BLK with ECO-FCP-55BS

The 10 Button Control Plate provides eight configurable buttons allowing scene recall, impulse and toggle and two multifunction buttons providing On & Raise and Off & Lower with integral IR receiver. All buttons have integral RGB LED's.



### MultiSensor ECO-MSR-0103

The manner in which the MultiSensor controls lighting is totally flexible. Each sensing element of the MultiSensor can be individually programmed to operate any light or output, or influence a control sequence.



### DALI Controller Single Univers ECO-DAC-6401

DALI ballasts/devices can be connected to the DALI control cable which is connected to and managed by the DALI Controller. Each DALI Ballast Module can control up to 64 ballasts/ devices as the primary means of luminaire control.



### Area Controller ECO-LAC-6401

An installation is divided into logical areas which may be dictated by individual tenancies or the physical layout and practicalities of the installation.

## Wiring Overview

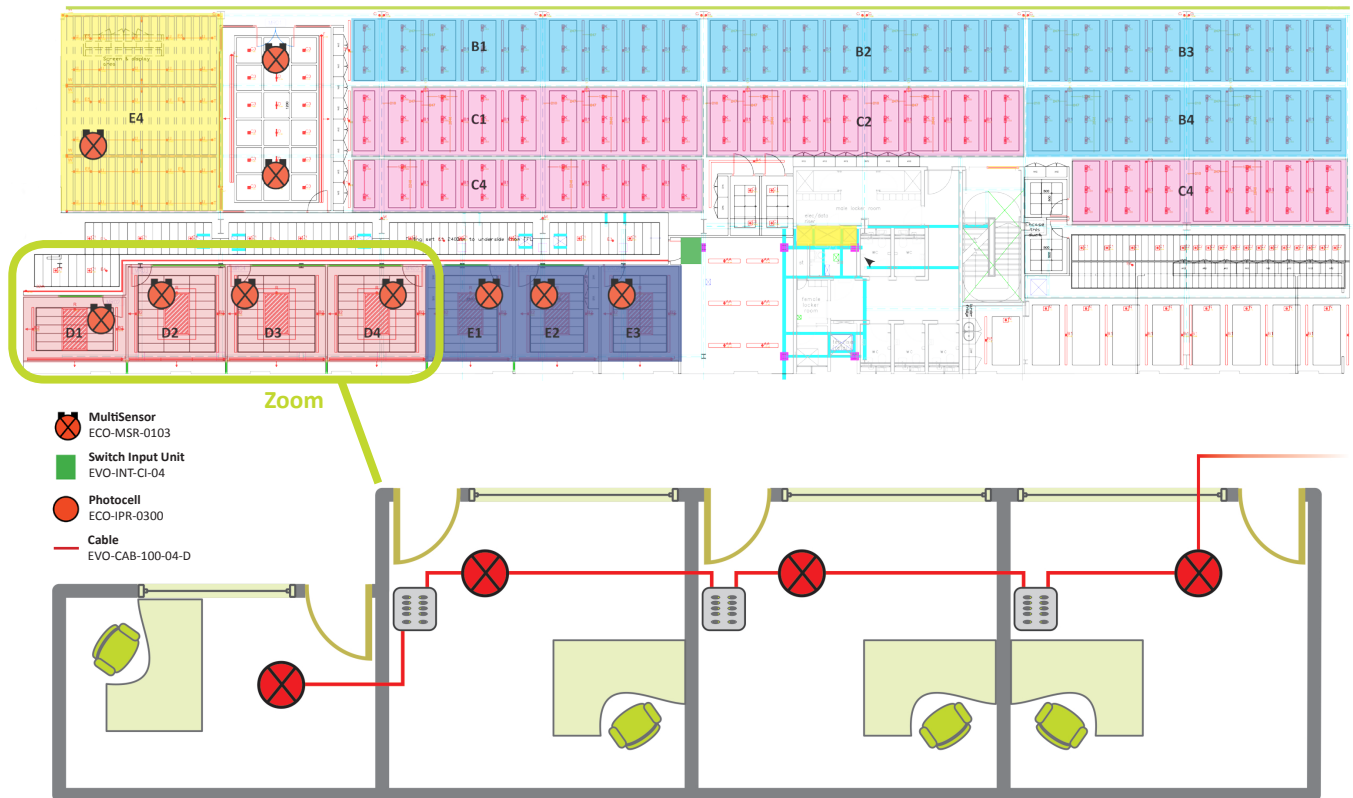

Please scan for more information



Mode Lighting (UK) Limited  
 The Maltings, 63 High Street, Ware, Hertfordshire, SG12 9AD, United Kingdom  
 Telephone: +44 (0) 1920 462 121 Facsimile: +44 (0) 1920 466 881  
 email: sales@modelighting.com or visit us online [www.modelighting.com](http://www.modelighting.com)